



Innes Gardens, SW15

£595 pw

3 bedroom flat to rent

Description

This Fourth Floor apartment with a lift and balcony overlooking communal gardens is offered for rental having recently been repainted throughout.

Offering two/three bedrooms with a bathroom and a separate shower room.

*Wooden Floored Double Reception with a balcony * Fitted Kitchen *
Two Double Bedrooms * Single Bedroom/Study * Bathroom *
Shower Room * Lift * Free on-site Parking Permit available *
Communal Gardens * Close to Putney Heath and Roehampton
Village * Partly furnished

Council Tax Band: B

Deposit: £2,975

Holding Deposit: £595



Innes Gardens, SW15

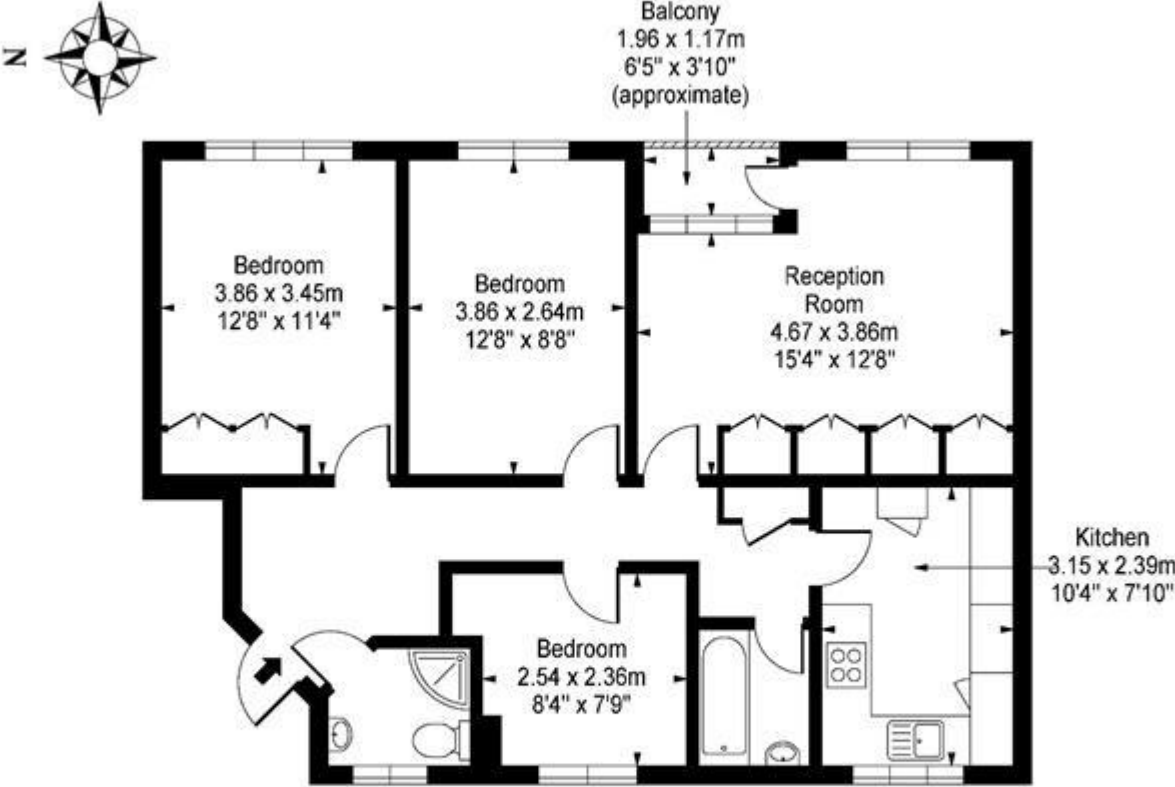

Fourth Floor

Approx Gross Internal Area 768 Sq Ft - 71.35 Sq M

This floor plan should be used as a general outline for guidance only and does not constitute in whole or in part an offer or contract. Any intending purchaser or lessee should satisfy themselves by inspection, searches, enquiries and full survey as to the correctness of each statement. Any areas, measurements or distances quoted are approximate and should not be used to value a property or be the basis of any sale or let.

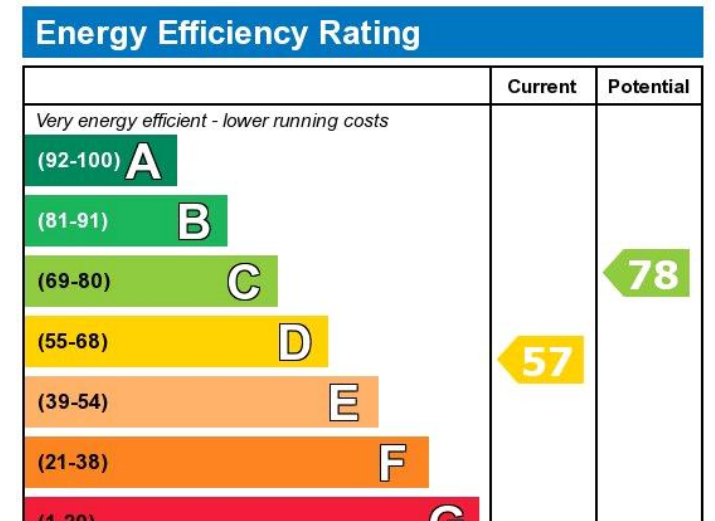

Viewing by appointment only
 Milton Stone - Head Office
 53 Abingdon Road, London W8 6AN
 Tel: 0207 938 2311 Email: sophie@miltonstone.com Website: <http://www.miltonstone.com>