



MILTON
STONE

St Helens Gardens, London, W10

£425,000 Leasehold

Studio for sale

Description

A spacious and recently refurbished studio apartment in this well managed and secure block within walking distance of the extensive local amenities. The property boasts a large separate kitchen, wooden flooring throughout and offers bright and well-proportioned living space

Lease is 125 years.

Ground Rent is £250 per year.

Service charge is currently £1,300 per annum.

Tenure: Leasehold

Tenure

Leasehold



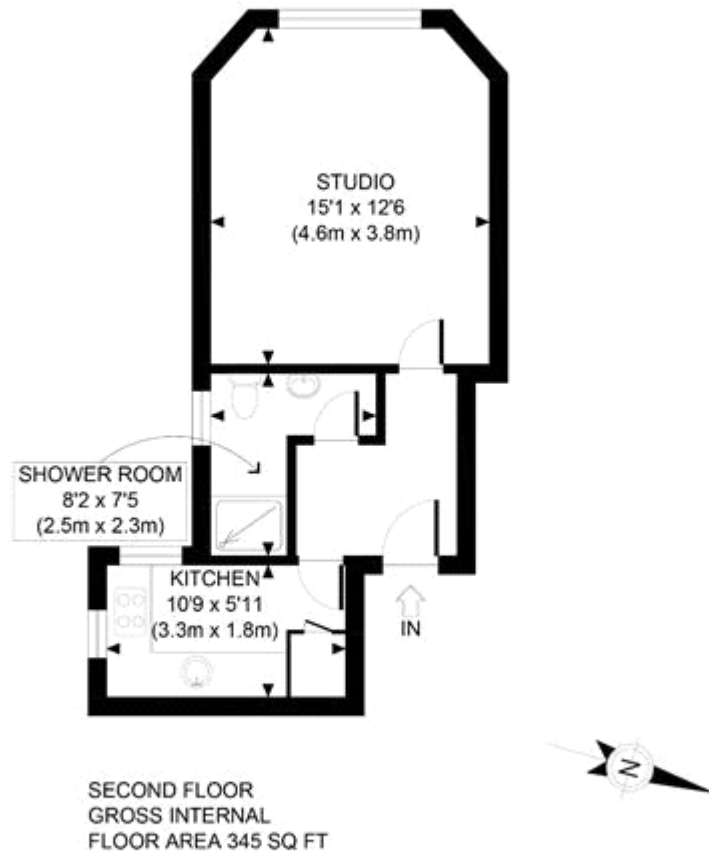

<p>APPROX. GROSS INTERNAL FLOOR AREA 345 SQ FT / 32 SQM</p> <p>Disclaimer: Floor plan measurements are approximate and are for illustrative purposes only. While we do not doubt the floor plan accuracy and completeness, you or your advisors should conduct a careful, independent investigation of the property in respect of monetary valuation</p>	<p>Helens GDNS</p>
	<p>date 02/02/21</p>
	<p>photoplan </p>



Energy Efficiency Rating		Environmental Impact (CO ₂) Rating	
Current	Potential	Current	Potential
Very energy efficient - lower running costs (92-100) A (81-91) B (69-80) C (55-68) D (39-54) E (21-38) F (1-20) G Not energy efficient - higher running costs		Very environmentally friendly - lower CO ₂ emissions (92-100) A (81-91) B (69-80) C (55-68) D (39-54) E (21-38) F (1-20) G Not environmentally friendly - higher CO ₂ emissions	
	82	86	
			78
			78
England & Wales EU Directive 2002/91/EC		England & Wales EU Directive 2002/91/EC	
The energy efficiency rating is a measure of the overall efficiency of a home. The higher the rating the more energy efficient the home is and the lower the fuel bills will be.		The environmental impact rating is a measure of a home's impact on the environment in terms of carbon dioxide (CO ₂)	

Viewing by appointment only
 Milton Stone - Head Office
 53 Abingdon Road, London W8 6AN
 Tel: 0207 938 2311 Email: info@miltonstone.com Website: www.miltonstone.com

